

BERKELEY COUNTY PUBLIC SERVICE WATER DISTRICT  
 BERKELEY COUNTY, WEST VIRGINIA

Contract Drawings

for

POTOMAC RIVER  
 WATER TREATMENT FACILITY  
 CIP CHEMICAL FEED UPGRADE

CONTRACT No. 4: GENERAL-MECHANICAL AND ELECTRICAL WORK

2017

**GD&F**

GWIN  
 DOBSON &  
 FOREMAN INC.

*Consulting Engineers*

3121 Fairway Drive  
 Altoona, PA 16602  
 Phone: (814) 943-5214  
 Fax: (814) 943-8494  
 www.gdfengineers.com

RE-BID 10-3-17

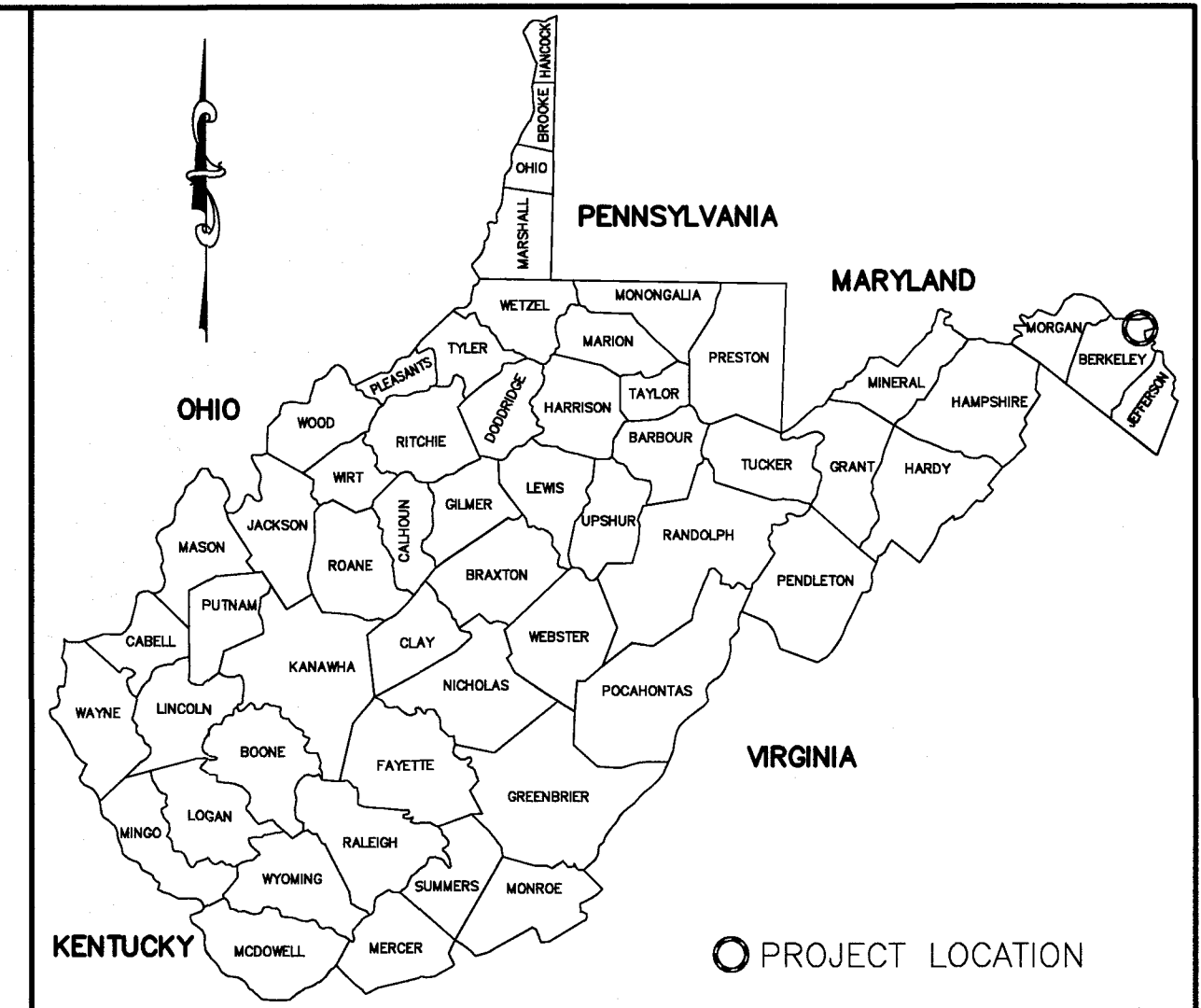

VICINITY MAP

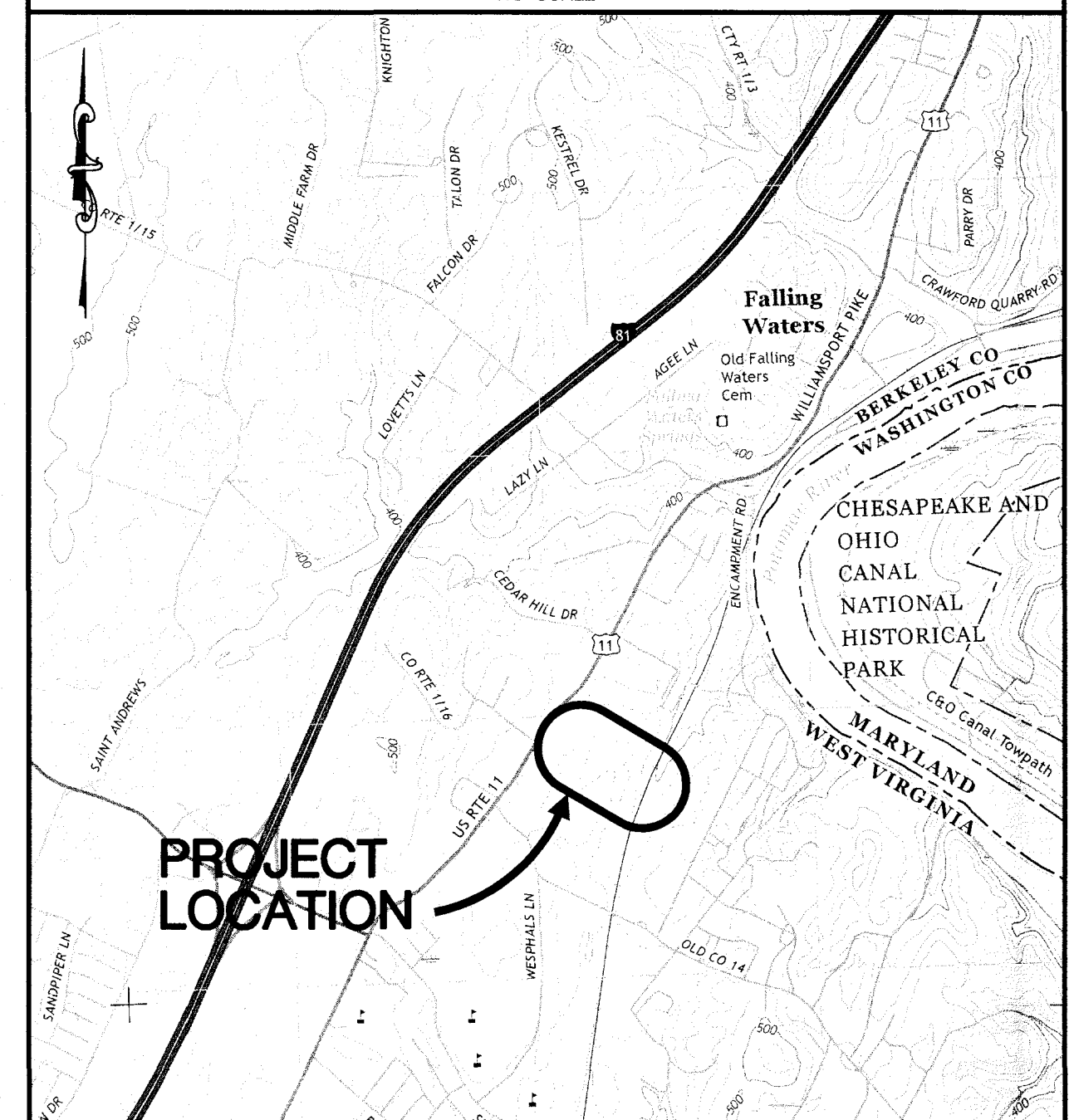

LOCATION MAP

**DRAWING INDEX**

- CS-1 COVER SHEET
- R-1 EXISTING TREATMENT BUILDING GROUND LEVEL MECHANICAL FLOOR PLAN
- R-2 EXISTING TREATMENT BUILDING BASEMENT LEVEL MECHANICAL FLOOR PLAN
- D-1 C.I.P. SYSTEM DEMOLITION FLOOR PLAN
- D-2 C.I.P. TANK AND PUMPS DEMOLITION SECTION
- D-3 LIQUID CHEMICAL FEED STATIONS DEMOLITION FLOOR PLAN AND SECTIONS
- D-4 LIQUID CHEMICAL FEED STATIONS SCHEMATIC DEMOLITION DETAILS
- M-1 LIQUID CHEMICAL FEED STATIONS MODIFICATION FLOOR PLAN AND SECTIONS
- M-2 CHEMICAL FEED PIPING MODIFICATION SCHEMATIC BASEMENT LEVEL FLOOR PLAN
- M-3 DETAILS
- M-4 WEST EXTERIOR ELEVATION
- M-5 TREATMENT BUILDING BASEMENT LEVEL MECHANICAL PIPE SUPPORT MODIFICATION FLOOR PLAN
- E-1 EXISTING TREATMENT BUILDING GROUND LEVEL POWER PLAN
- E-2 LIQUID CHEMICAL FEED STATIONS MODIFICATION POWER AND DEMOLITION PLANS
- E-3 PANEL SCHEDULE MODIFICATION
- E-4 EXISTING TREATMENT BUILDING BASEMENT LEVEL LIGHTING AND CONDUIT SUPPORT MODIFICATION PLAN

| NO.     | DATE | DESCRIPTION    |
|---------|------|----------------|
| 10-3-17 |      | RE-BID         |
| 8-22-17 |      | ISSUED FOR BID |

|  |               |  |
|--|---------------|--|
| COVER SHEET  |               | <b>GD&amp;F</b><br>GWIN<br>DOBSON &<br>FOREMAN<br>ENGINEERS<br>3121 Fairway Drive<br>Altoona, PA 16602<br>814.943.5214<br>gdfengineers.com |
| BERKELEY COUNTY PUBLIC<br>SERVICE WATER DISTRICT<br><br>POTOMAC RIVER<br>WATER TREATMENT FACILITY<br>CIP CHEMICAL FEED UPGRADE<br><br>BERKELEY COUNTY, WEST VIRGINIA |               |  |
| DATE: 8-22-17  | JOB: 14050    | SCALE: AS SHOWN  |
| FILE: 14050_CS-1   | DRAWN BY: RLN | CHECKED BY: CME  |
|  |               | SHEET NO:<br><b>CS-1</b>   |

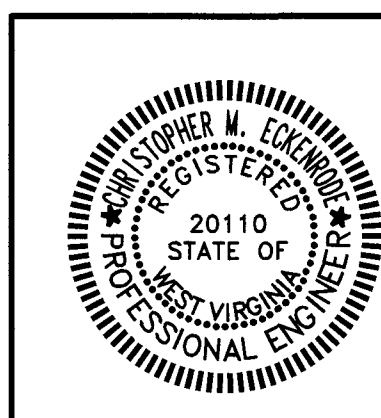

PLOT CREATED: 10/17/2017 9:36 AM

160'-8"

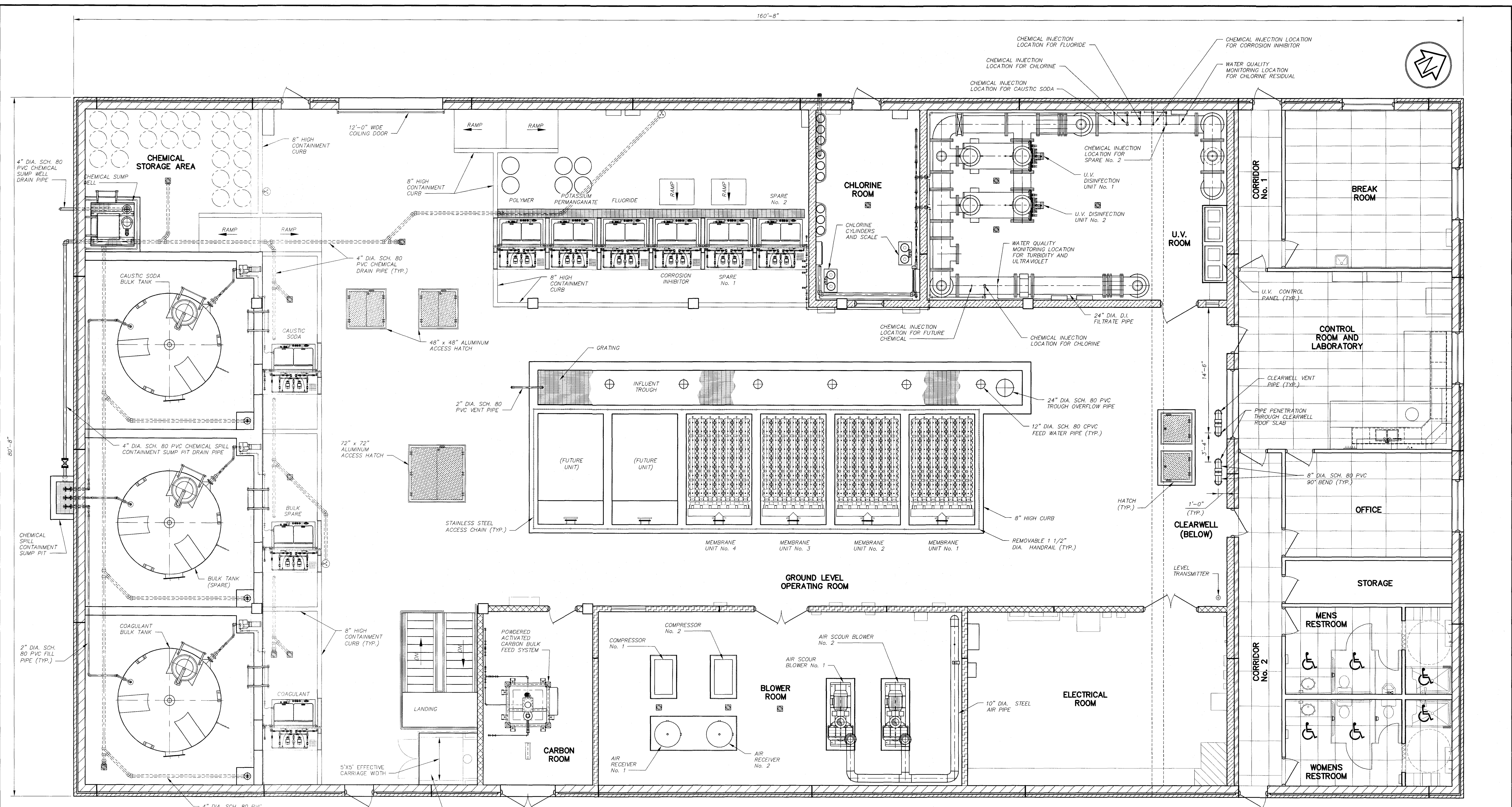

### GROUND LEVEL MECHANICAL FLOOR PLAN

SCALE: 3/16" = 1'-0"

FOR INFORMATION  
PURPOSE ONLY!

| NO.     | DATE | DESCRIPTION    |
|---------|------|----------------|
| 10-3-17 |      | RE-BID         |
| 8-22-17 |      | ISSUED FOR BID |

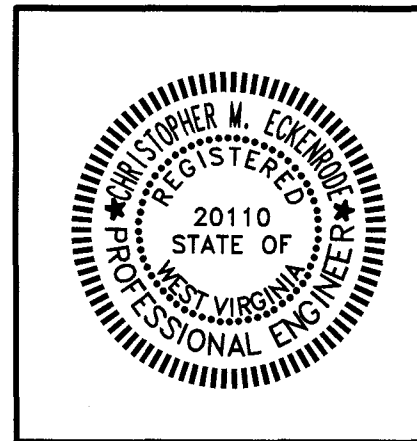

EXISTING TREATMENT BUILDING GROUND  
LEVEL MECHANICAL FLOOR PLAN

BERKELEY COUNTY PUBLIC  
SERVICE WATER DISTRICT

**POTOMAC RIVER  
WATER TREATMENT FACILITY  
CIP CHEMICAL FEED UPGRADE**

BERKELEY COUNTY, WEST VIRGINIA

**GD&F**  
GWIN  
DOBSON &  
FOREMAN  
ENGINEERS

3121 Fairway Drive  
Altoona, PA 16602  
814.943.5214  
gdfeengineers.com

|                 |               |                 |
|-----------------|---------------|-----------------|
| DATE: 8-22-17   | JOB: 14050    | SCALE: AS SHOWN |
| FILE: 14050_R-1 | DRAWN BY: RLN | CHECKED BY: CME |

SHEET NO:  
**R-1**

PLOT CREATED: 10/3/2017 9:37 AM